



The Hexagon, Kempthorne Lane,

Price Guide £230,000

FOR SALE



- No Chain
- Kitchen/Lounge/Dining
- Allocated Parking
- Grade II Listed
- 2 Bedrooms
- Direct Bus Links To City Centre

THE PROPERTY

A fantastic opportunity for first-time buyers or investors alike. A lovely first floor apartment, in a Grade II Listed building, set in a quiet, off road location with the benefit of communal gardens and private parking. Close to local amenities and central bus routes.

Approx Gross Internal Area
53 sq m / 570 sq ft

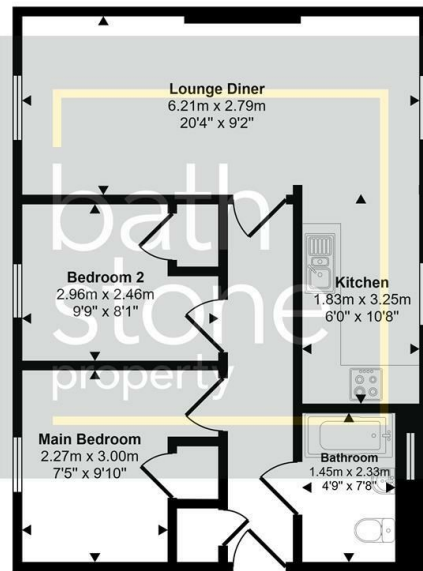

Floorplan

This floorplan is only for illustrative purposes and is not to scale. Measurements of rooms, doors, windows, and any items are approximate and no responsibility is taken for any error, omission or mis-statement. Icons of items such as bathroom suites are representations only and may not look like the real items. Made with Made Snappy 360.



Energy Efficiency Rating

	Current	Potential
Very energy efficient - lower running costs		
(92 plus) A		
(81-91) B		
(69-80) C	74	80
(55-68) D		
(39-54) E		
(21-38) F		
(1-20) G		
Not energy efficient - higher running costs		
England & Wales	EU Directive 2002/91/EC	